

Easy Cable Product Specification

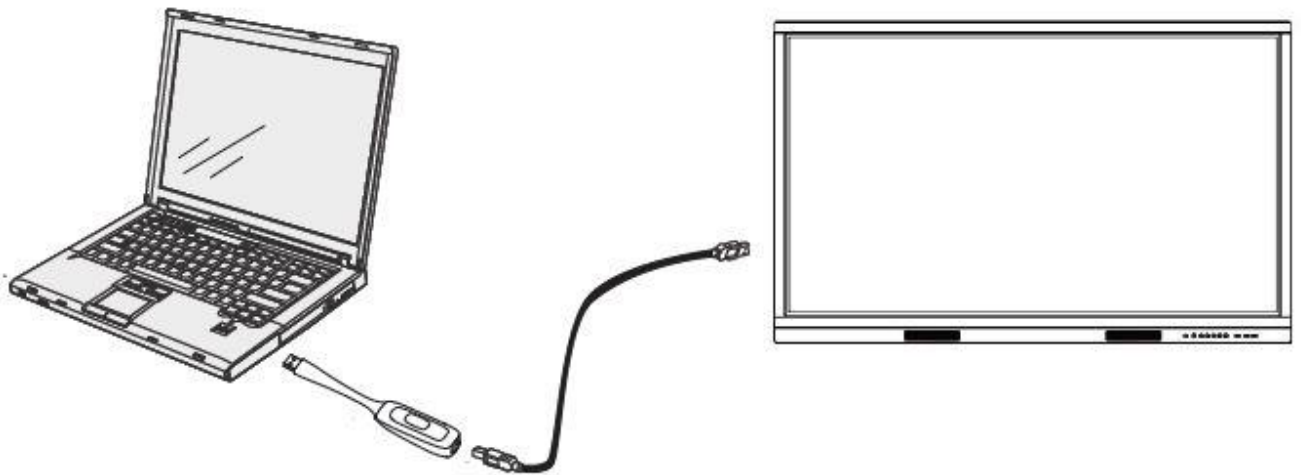

Product Features

Easy Cable is a cable solution to one-key share your PC/ Mobile Device screen upon ICE Board Interactive Flat Panels via USB port; it also provides reverse touch control to PC/ Mobile Device from ICE Board.

- **Easy Set Up**

One USB cable connection, drive free

- **Share Screen**

One button click for instant sharing

- **Mutual Operation**

Touch control the PC or Mobile Device through ICE Board Interactive Flat Panel

Product Specifications

Interface Specifications

USB2.0-A	1
USB2.0-B	1

Hardware Specifications

Indicator light	Indicate transmission status
Resolution	1920*1080@60Hz
System	Windows7/8/8.1/10, Mac OS X 10.9 and above
Transmission Distance	5m

Power Specifications

Power Requirements	5V DC
Power Consumption	≤2.5W

Physical Specifications

Key Number	1
Dimension L*H*W	187*28*24mm
Dimension (package) L*H*W	210*111*44mm
Net Weight	35g
Gross Weight	550g

Accessories

Operation Instructions	1
USB Touch Cable	1
Screw	2

Environmental Conditions

Operation Temperature	0°C-40°C
Operation Humidity	10% - 90%
Storage Temperature	-20°C-60°C
Storage Humidity	10% - 90%